

Verticale Vertical	Materiale Material	Pompa Pump	kW	Alimentazione (*) Feeding (*)	Giri/min. RPM	Portata max (l/min) Capacity max (l/min)	Prevalenza max (m) Head max (m)		
<b>GDV-BJ 3</b>	Bronzo Bronze	1	0.6	24V	2600	55 + 55	36		
		2	0.6	24V	2600		36		
		1	0.55	230V - 50Hz	2800	60 + 60	50		
		2	0.55	230V - 50Hz	2800		50		
		1	0.55	230/400V - 50Hz	2800	60 + 60	50		
		2	0.55	230/400V - 50Hz	2800		50		
		1	0.6	24V	2600	55 + 60	36		
		2	0.55	230V - 50Hz	2800		50		
<b>GDV-BJ 4</b>	Bronzo Bronze	1	0.75	24V	2800	70 + 70	42		
		2	0.75	24V	2800		42		
		1	0.75	230V - 50Hz	2800	75 + 75	42		
		2	0.75	230V - 50Hz	2800		42		
		1	0.75	230/400V - 50Hz	2800	75 + 75	42		
		2	0.75	230/400V - 50Hz	2800		42		
		1	0.75	24V	2800	70 + 75	42		
		2	0.75	230V - 50Hz	2800		42		
		<b>GDV-BJ 5</b>	Bronzo Bronze	1	1.1	230V - 50Hz	2800	100 + 100	50
				2	1.1	230V - 50Hz	2800		50
<b>GDV-BJ 6</b>	Bronzo Bronze	1	1.5	230V - 50Hz	2800	160 + 160	48		
		2	1.5	230V - 50Hz	2800		48		
		1	1.5	230/400V - 50Hz	2800	160 + 160	52		
		2	1.5	230/400V - 50Hz	2800		52		

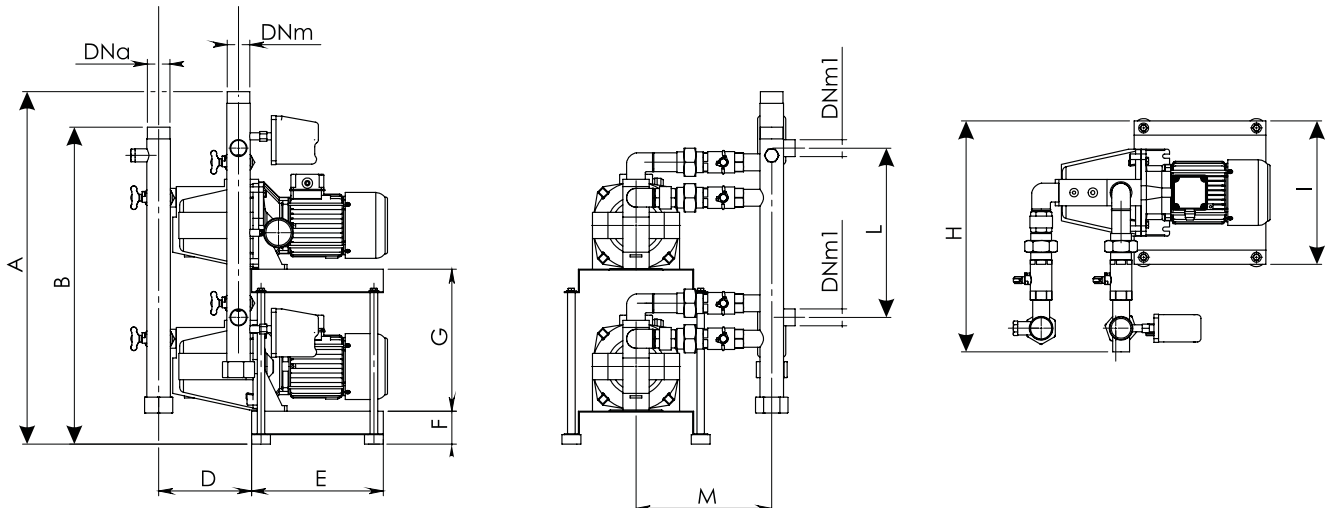

NB: versione standard del gruppo. Su richiesta possiamo modificare l'esecuzione per variare le dimensioni di ingombro.  
NB: standard arrangement of the group. Under request we can change the arrangement to modified the overall dimensions.

Modello Type	Dna (Gas-BSP)	Dnm (Gas-BSP)	Dnm 1 (Gas-BSP)	A	B	C	D	E	F	G	H	I	L	M	Peso / Weight (Kg)		
															DC-DC	AC-AC	AC-DC
<b>GDV-BJ 3</b>	1"1/2	1"1/2	1"	750	670	185	220	280	70	380	434	320	370	240	68	60	64
<b>GDV-BJ 4</b>	1"1/2	1"1/2	1"	750	670	185	220	280	70	380	434	320	370	240	70	62	66
<b>GDV-BJ 5</b>	2"	1"1/2	1"	780	700	230	260	320	70	380	460	350	370	280	83		
<b>GDV-BJ 6</b>	2"	1"1/2	1"	780	700	230	260	320	70	380	460	350	370	280	90		